

THE CITY OF BRADFORD METROPOLITAN DISTRICT COUNCIL
(54 LANE SIDE, WILSDEN, BRADFORD, WEST YORKSHIRE BD15 0LZ)
COMPULSORY PURCHASE ORDER 2023

THE HOUSING ACT 1985 PART II SECTION 17
AND
THE ACQUISITION OF LAND ACT 1981

The City of Bradford Metropolitan District Council (in this order called the “acquiring authority”) makes the following order: -

1. Subject to the provisions of this order, the acquiring authority is under section 17 of the Housing Act 1985 hereby authorised to purchase compulsorily the land described in paragraph 2 for the purpose of bringing the property back into use as a housing resource.
2. The land authorised to be purchased compulsorily under this order is the land described in the Schedule and delineated and shown outlined in red on a map prepared in duplicate, sealed with the common seal of the acquiring authority and marked “Map referred to in The City of Bradford Metropolitan District Council (54 Lane Side, Wilsden, Bradford, West Yorkshire BD15 0LZ) Compulsory Purchase Order 2023”.

SCHEDULE

Table 1

Extent, description and situation of the land	Qualifying persons under section 12(2)(a) of the Acquisition of Land Act 1981 – name and address			
	Owners or reputed owners	Lessees or reputed Lessees	Tenants or reputed tenants (other than lessees)	Occupiers
54 Lane Side, Wilsden, Bradford, West Yorkshire BD15 0LZ (covering 243 square metres) - WYK448460 - Dwellinghouse		-	-	Unoccupied

Table 2

Other qualifying persons under section 12(2A)(a) of the Acquisition of Land Act 1981		Other qualifying persons under section 12(2A)(b) of the Acquisition of Land Act 1981 – not otherwise shown in Tables 1 & 2	
Name and address	Description of interest to be acquired	Name and address	Description of the land for which the person in adjoining column is likely to make a claim
-	-	-	-

IN WITNESS WHEREOF City of Bradford Metropolitan District Council have hereunto affixed their Common Seal on this 23 day of MARCH 2023



Authorised by Director of Legal & Governance



102238 A

MAP REFERRED TO
 IN THE CITY OF BRADFORD
 METROPOLITAN DISTRICT COUNCIL
 (54 LANE SIDE, WILSDEN, BRADFORD, WEST YORKSHIRE BD15 0LZ)
 COMPULSORY PURCHASE ORDER 2023

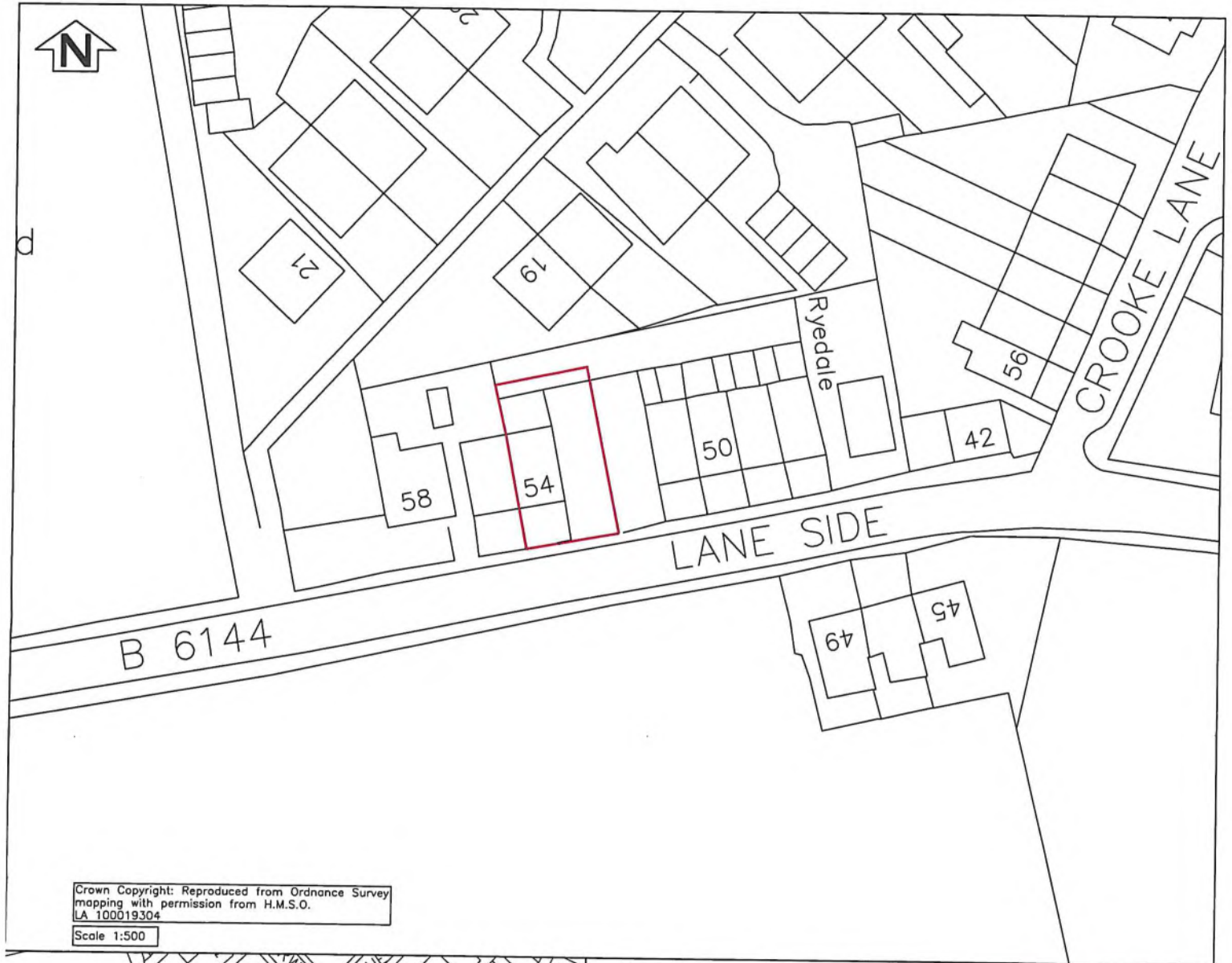

Crown Copyright: Reproduced from Ordnance Survey mapping with permission from H.M.S.O.
 LA 100019304

Scale 1:500

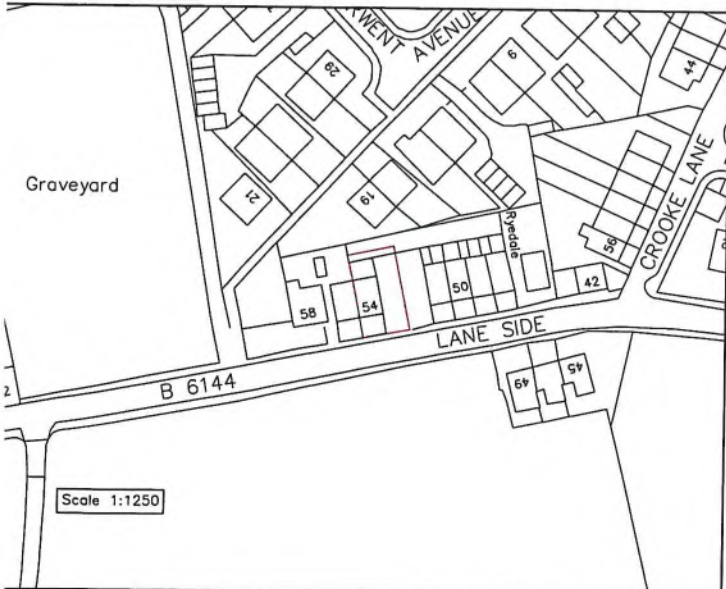

Scale 1:1250

Executed as a deed by affixing the Common Seal of City of Bradford Metropolitan District Council in the presence of:

Authorised by: *City Solicitor*

DIRECTOR OF LEGAL AND GOVERNANCE



Murphy

(022380)