

NOTES:

Do not scale from this drawing, use figured dimensions only. Notify Project Manager of any discrepancies. This drawing is to be read in conjunction with all other contract documents and drawings. This drawing is subject to confirmation by site survey.

All work to be in accordance with the current Building Regulations, current good practise & Construction, Design & Maintenance Regulations.

It is drawn to your attention that this drawing is a copyright work. The copyright is owned by the City of Bradford Metropolitan District Council and use of all or part of this work without the written permission of the City of Bradford Metropolitan District Council will be in breach of copyright. It is also drawn to your attention that the drawing(s) were drawn up for specific projects. Use of all or part of this drawing for any project other than that for which it has been specifically produced may result in an inappropriate drawing being used and could be dangerous/neglect.

This drawing is for viability information only and should not be used for any other purpose.

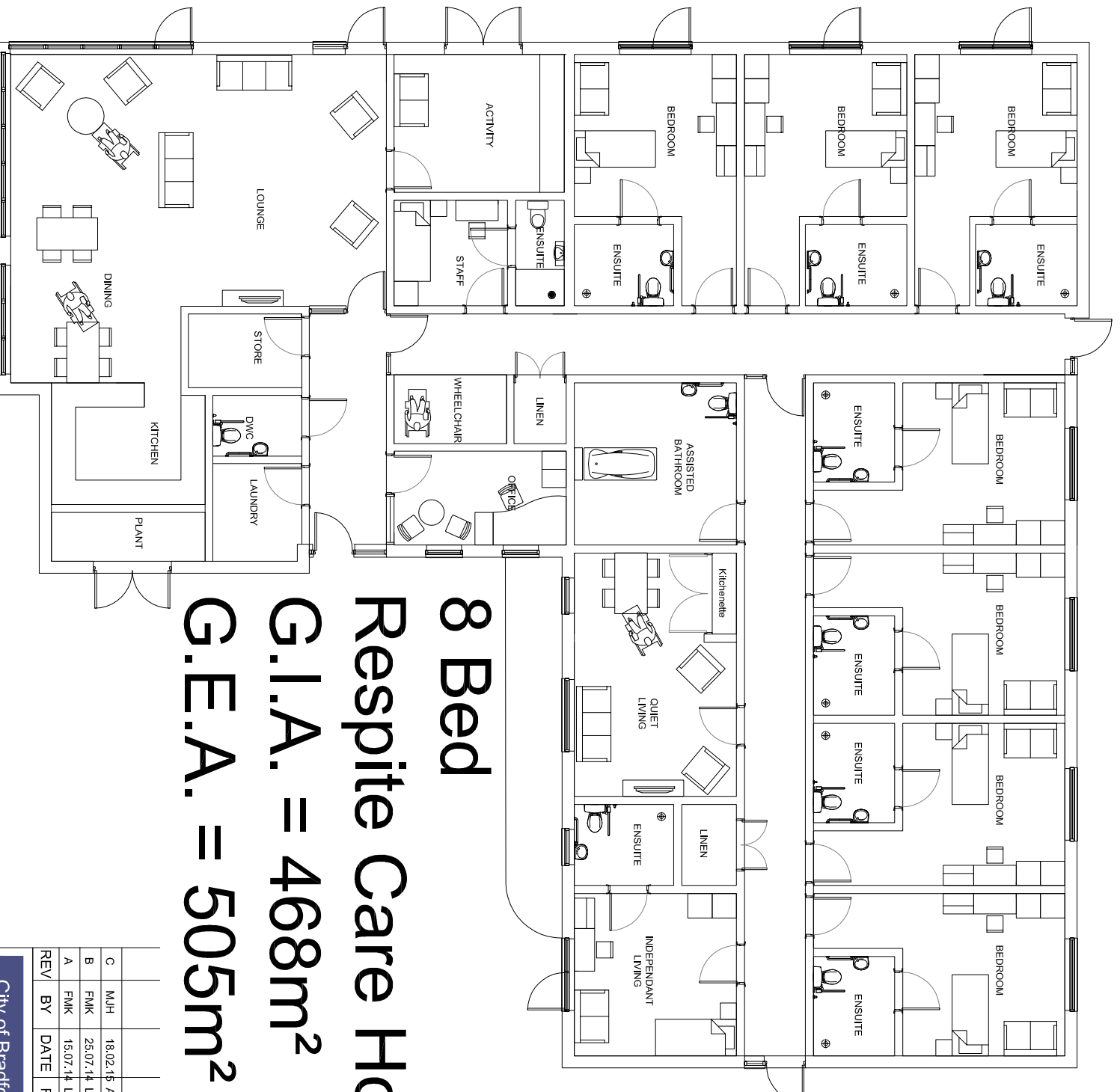

**8 Bed
Respite Care Home**
G.I.A. = 468m²
G.E.A. = 505m²

REV	BY	DATE	REVISION DESCRIPTION
C	MJH	18.02.15	Areas Reappraised. Client fix of footprint
B	FMK	25.07.14	Living and dining relocated
A	FMK	15.07.14	L Shaped layout

Viability Stage

City of Bradford Metropolitan District Council <small>www.bradford.gov.uk</small>	
Department of Regeneration and Culture Economic Development & Property Architectural Services Assistant Director: Mike Cowden <small>8th Floor, Jacobs Wall, Nelson Street, Bradford, BD1 1SNW Tel: (01274) 433942 Fax: (01274) 433983</small>	
CLIENT: Adult and Community Services	
PROJECT: Branshaw Respite Care home Oakworth Road	
DRAWING: Proposed Plan	
PROJECT MANAGER: Fiona Kelly	OS REF:
DRAWN BY: FMK	DATE: 23.09.13
APPROVED:	SCALE: 1:200
DRAWING No. AR/892476022/11	REVISION No. C