

CONSULTATION DOCUMENT

St Joseph's Catholic College

Cunliffe Road,
Bradford,
BD8 7AP

Ward: MANNINGHAM

Head Teacher:

Patrick McDermott

Current School Population

978

Anticipated School Population at 2018:

1,360

Priority Admission Area:

Details of the school's admission policy can be downloaded from the Education Bradford website (www.educationbradford.com) : "A guide for parents about admission arrangements to Secondary Schools 2009-2010"

Existing School Layout



Please note that structural surveys and ground investigation surveys will be carried out at the school and/or other sites that are being proposed in the options below. These surveys will be carried out in the two week Easter holidays and non intrusive surveys being carried out at other times. Findings from these surveys will further inform our option appraisal.

OPTION 1

Option 1 proposes to complement the capital work currently undertaken by the diocesan authority and to replace blocks 2, 3, 5, 6 and 11 with new accommodations alongside new sport facilities. The remaining of the school would then be either refurbished or remodelled. Outdoor sport facilities would be relocated nearer the sport hall and car parking positioned at the top of the campus instead of its current central location

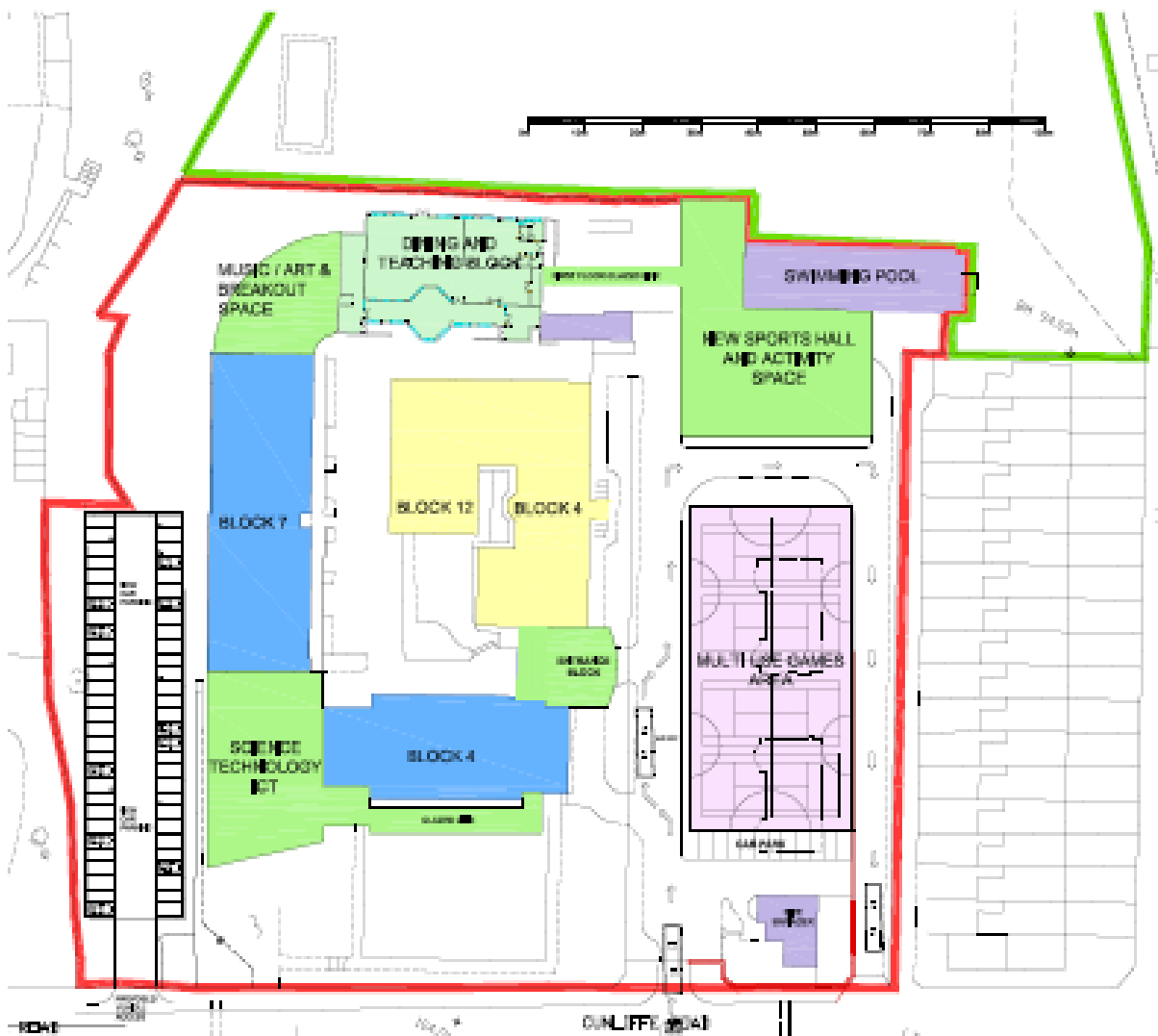

Advantages

- Improved links between the different blocks will improve flows of students.
- New car parking facilities will minimize reliance on external parking facilities
- No major issues from a planning perspective
- No implications from a Sport England perspective
- Careful phasing of the construction phase will minimize any decanting requirements

Disadvantages

- A thorough grounds survey of the area is required to ensure the viability of this option.

OPTION 2

Same than option 1 except the proposal to introduce an outdoor covered area between Blocks 4 and 7.

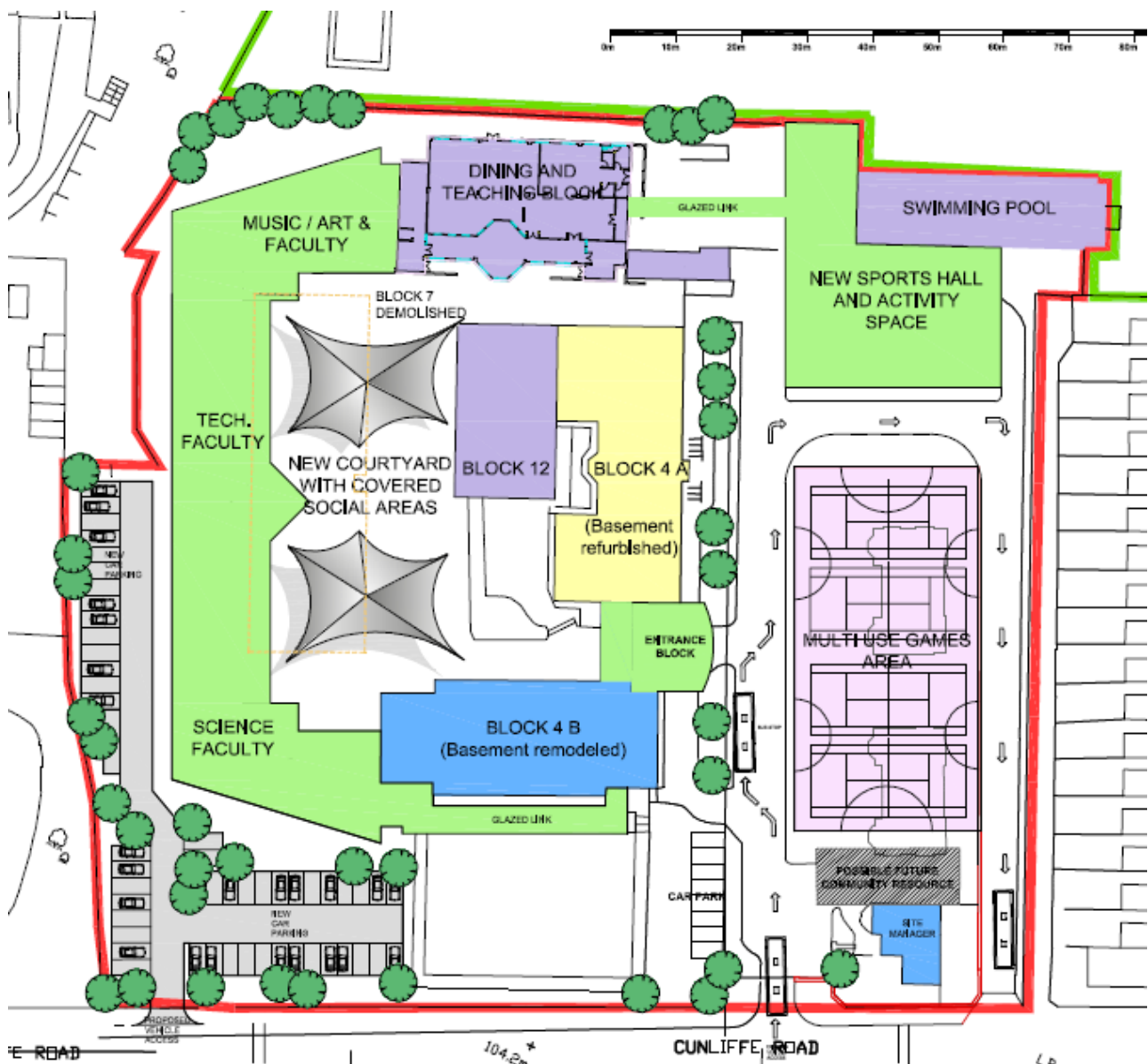

Advantages

- Improved links between the different blocks will improve flows of students.
- New car parking facilities will minimize reliance on external parking facilities
- No major issues from a planning perspective
- No implications from a Sport England perspective
- Careful phasing of the construction phase will minimize any decanting requirements

Disadvantages

- A thorough grounds survey of the area is required to ensure the viability of this option.

Building Schools for the Future Consultation Feedback

Bradford Council is keen to hear your opinion with regards to the proposed options put forward for the schools involved in the Building Schools for the Future (BSF) Phase 3 Programme and to seek your support and views on this exciting project.

Please complete this consultation questionnaire to let us know your views about the options available for **St Joseph's Catholic College**.

1. **Please rank** your preferred option for the school by reference (i.e. option 1 or 2):

Preferred option

Acceptable Option

2. **Additional comments you wish to make:**



3. About yourself (please tick as applicable):

Parent or carer of Primary school age child/ren

Parent or carer of Secondary school age child/ren

School Staff

School Governor

Member of the Local Community

A pupil ([Primary school)

A pupil (Secondary school)

Other

Please indicate your postcode

The consultation will end on Friday 3rd April. A summary analysis of responses will be subsequently produced which will inform the authority's decisions. These will be posted on the Bradford BSF website.

Should you have any queries about the consultation procedure please phone: 01274 437520.

Responses can be made:

By post to:

BSF Phase 3 Consultation
4th Floor, Merchants House
19 Peckover Street
BRADFORD BD1 5BD

By email to: merchants.house@bradford.gov.uk

By visiting our website: www.bradford.gov.uk/bsf

